

02-MAR-2018 14:58
c:\img\seal\seal.dwg
Mar-ch-2018 Chatham_Lee\2019_SEAL_MAPS.dgn
04003

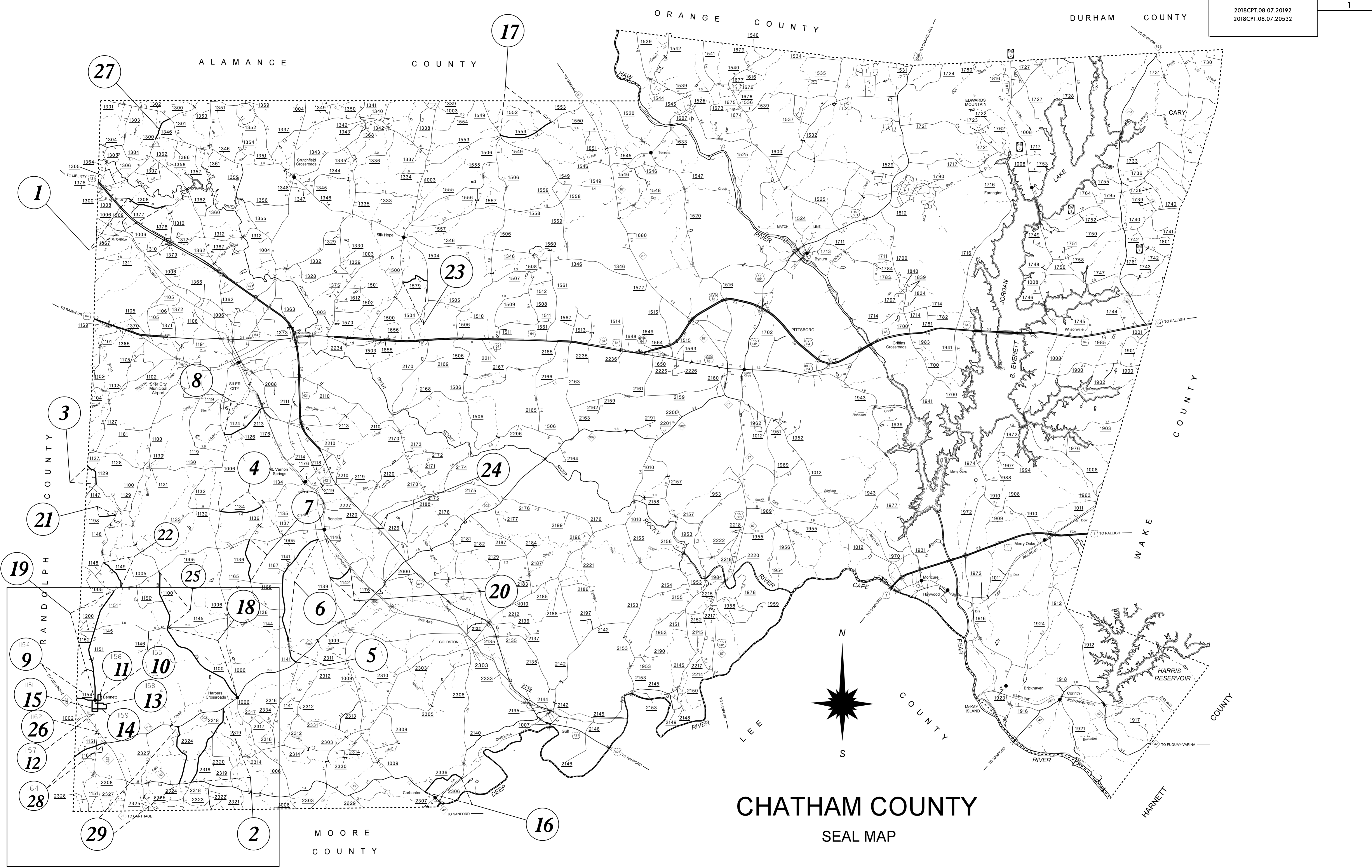

INSET "A"

CHATHAM COUNTY

SEAL MAP

DETAILS OF PATCHING EXISTING PAVEMENT PRIOR TO RESURFACING

DETAIL

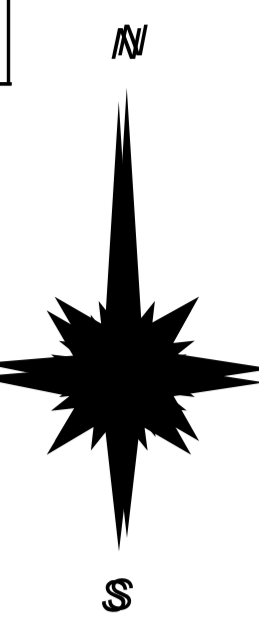
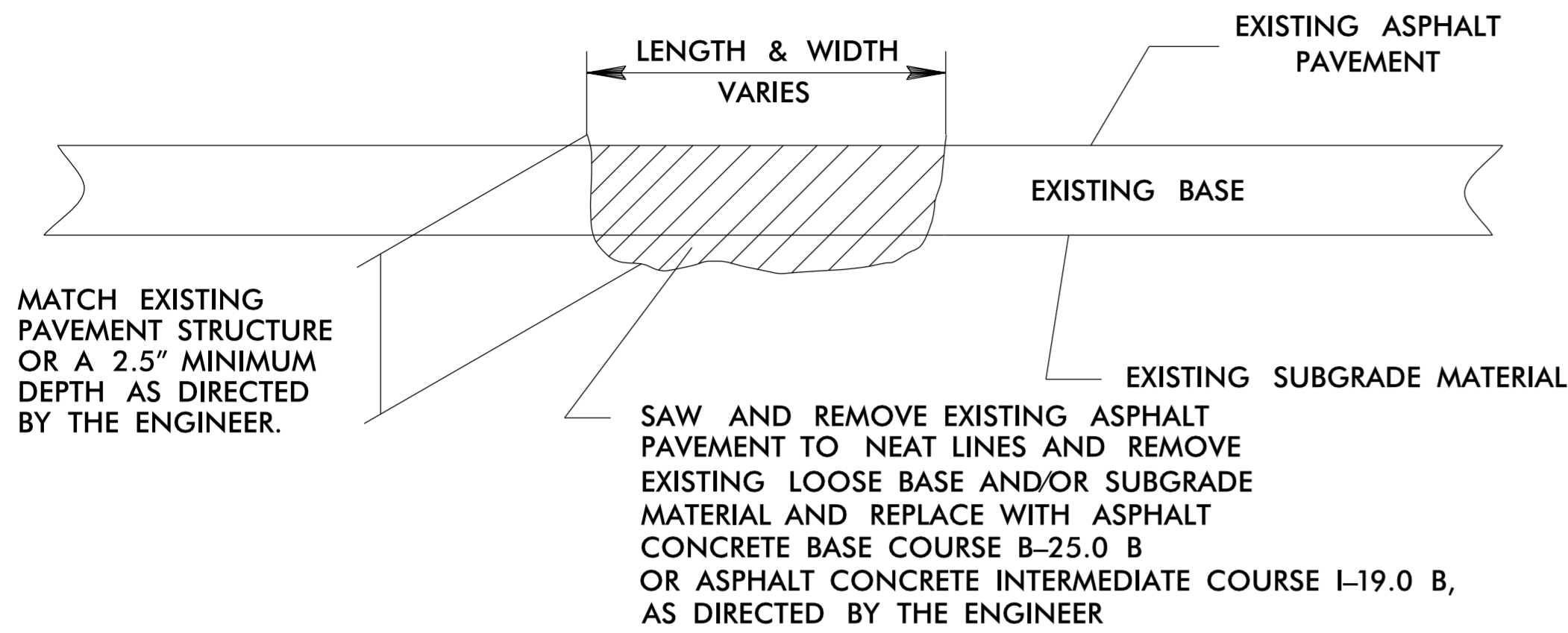

MAP# 1	SR 1308 (CHARLIE COOPER RD.)
MAP# 2	SR 2318 (RONALD SCOTT RD.)
MAP# 3	SR 1129 (LAMBERT CHAPEL RD.)
MAP# 4	SR 1134 (MT. VERNON SPRINGS RD.)
MAP# 5	SR 1141 (EDWARDS HILL CHURCH RD.)
MAP# 6	SR 1141 (EDWARDS HILL CHURCH RD.)
MAP# 7	SR 1136 (PALMERS CHAPEL RD.)
MAP# 8	SR 1124 (GLOSSON RD.)
MAP# 16	SR 2336 (INDIAN CREEK ESTATES)
MAP# 17	SR 1553 (PETE THOMAS RD.)
MAP# 18	SR 1100 (DEVIL TRAMPLING GROUNDS)
MAP# 19	SR 1151 (BONLEE- BENNETTE RD.)
MAP# 20	SR 1142 (HANNERTOWN RD.)
MAP# 21	SR 1198 (JIM GILLILAND RD.)
MAP# 22	SR 1149 (JAMES CAVINESS RD.)
MAP# 23	SR 1579 (ARCHIE JOHNSON RD.)
MAP# 24	SR 2126 (ELMER MOORE RD.)
MAP# 25	SR 1100 (DEVILS TRAMPLING GROUNDS)
MAP# 27	SR 2126 (PIKE RD.)
MAP# 28	SR 1100 (JERRY FRYE RD)
MAP# 29	SR 2324 (WINFRED BRADY RD)

MAP# 9	SR 1154 (BUFFALO ST.)
MAP# 10	SR 1155 (BUFFALO ST.)
MAP# 11	SR 1156 (LANE ST, VANCE ST, LEE ST, LOOP RD.)
MAP# 12	SR 1157 (LEE ST./E. BONLEE ST.)
MAP# 13	SR 1158 (LIBERTY ST. EAST.)
MAP# 14	SR 1159 (E./W. CARTHAGE ST.)
MAP# 15	SR 1151 (CHATHAM ST.)
MAP# 26	SR 1162 (RANDOLPH ST.)

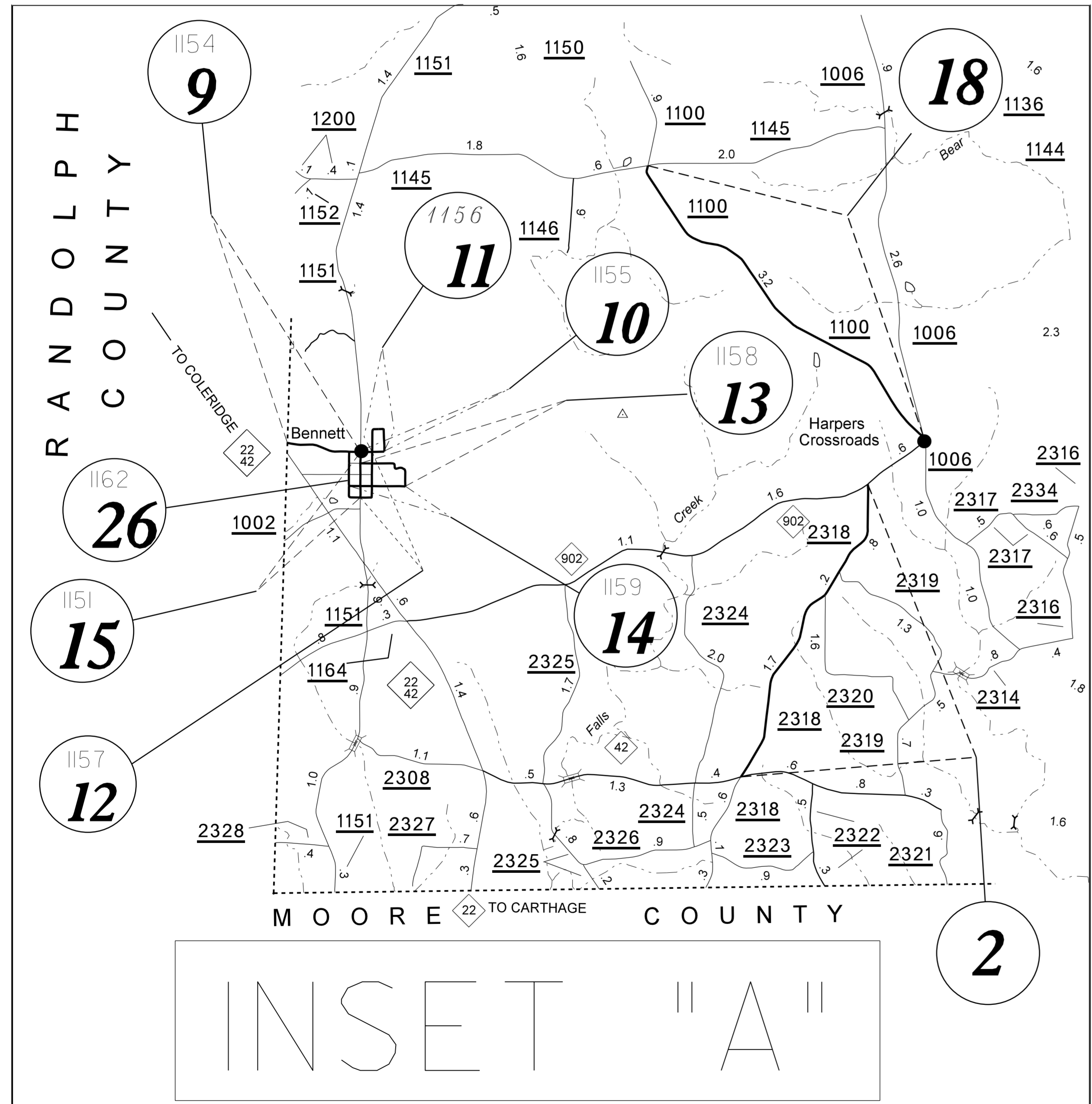

02-MAR-2018 14:58 C:\img\SEAL\SEAL_SAT\Map\2019_SEAL_MAPS.dgn

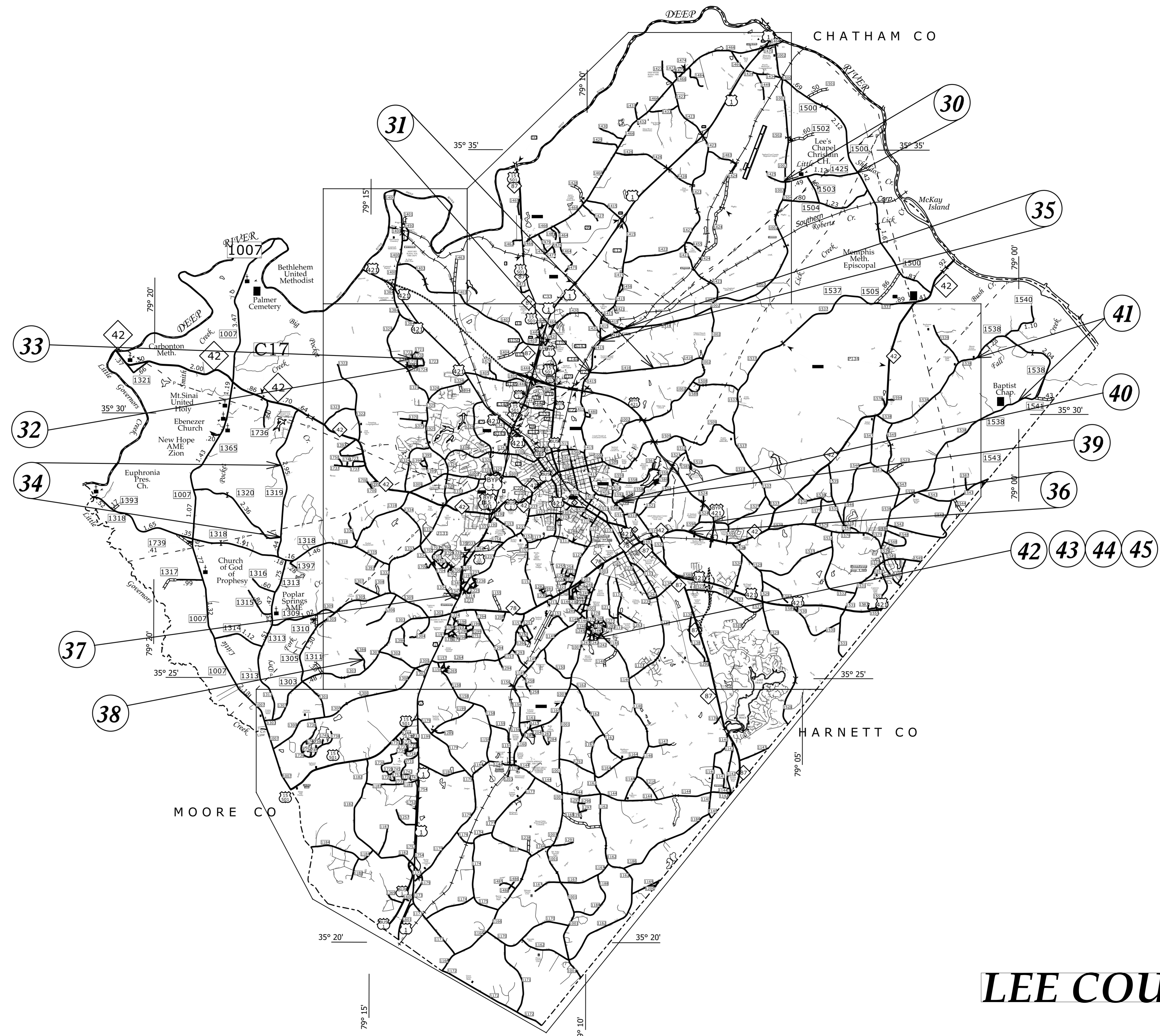

LEE COUNTY

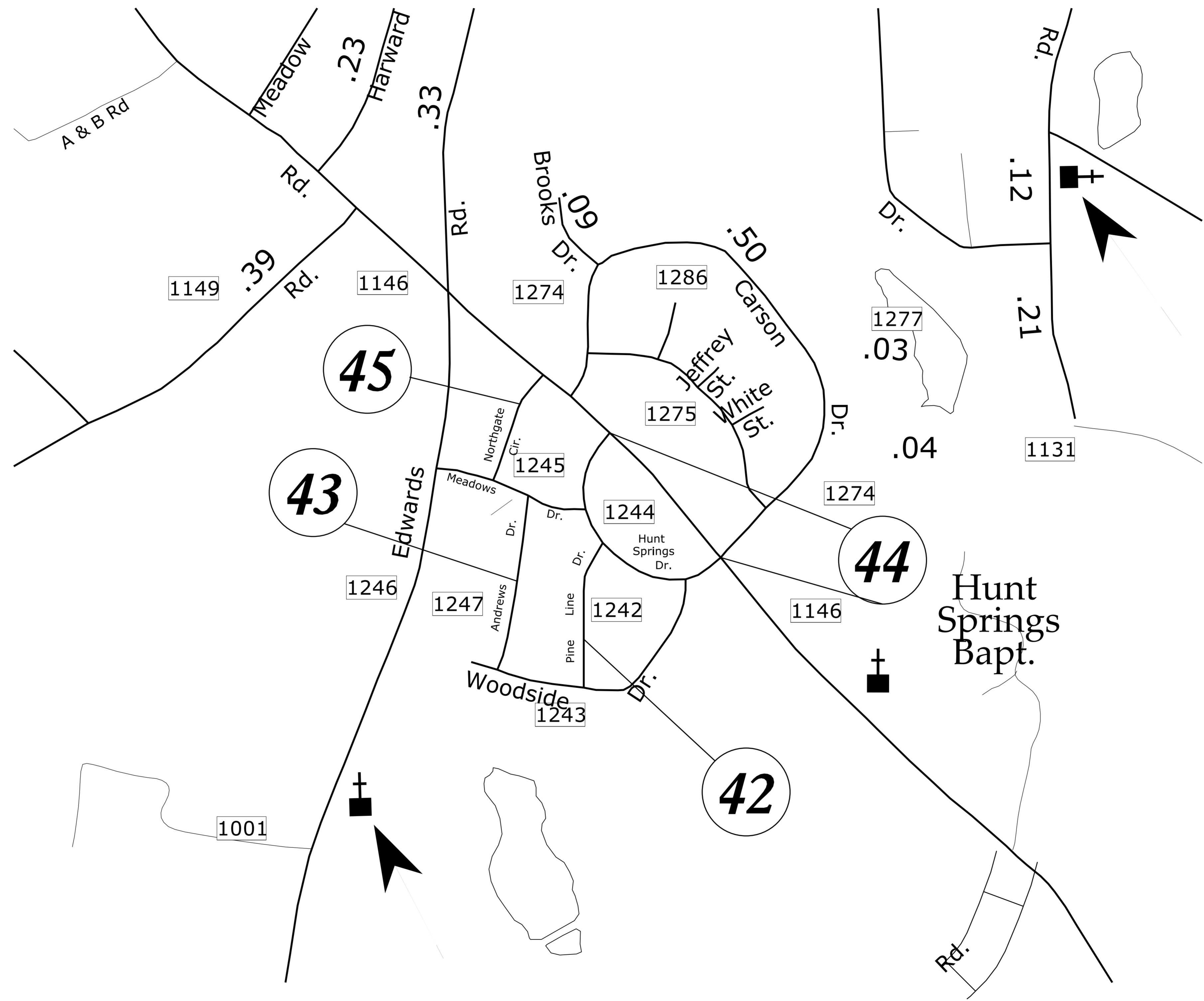

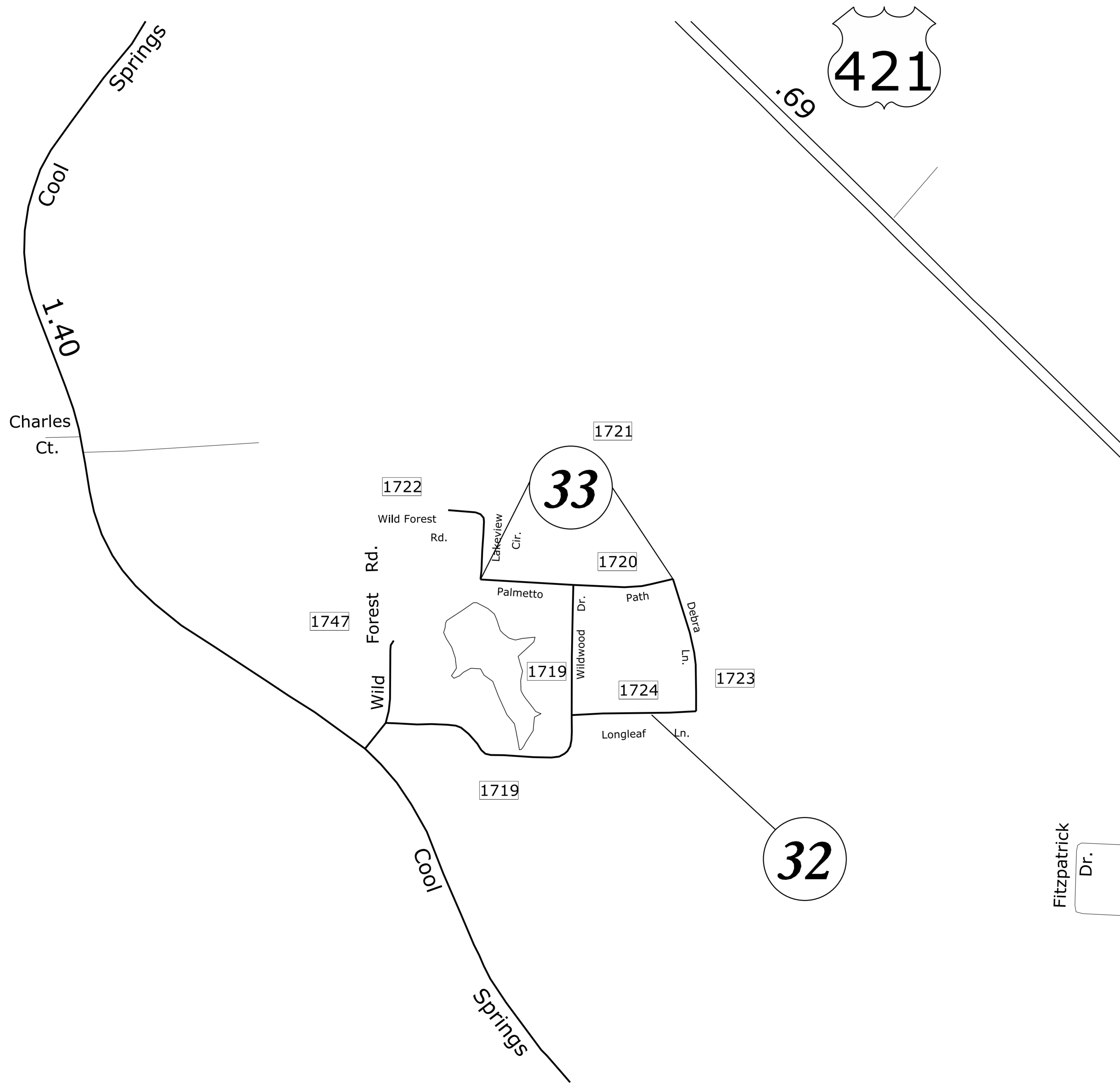

SIGNING FOR ASPHALT SURFACE TREATMENT

LEGEND

- ◻ PORTABLE SIGN
- └ STATIONARY SIGN
- ← DIRECTION OF TRAFFIC FLOW

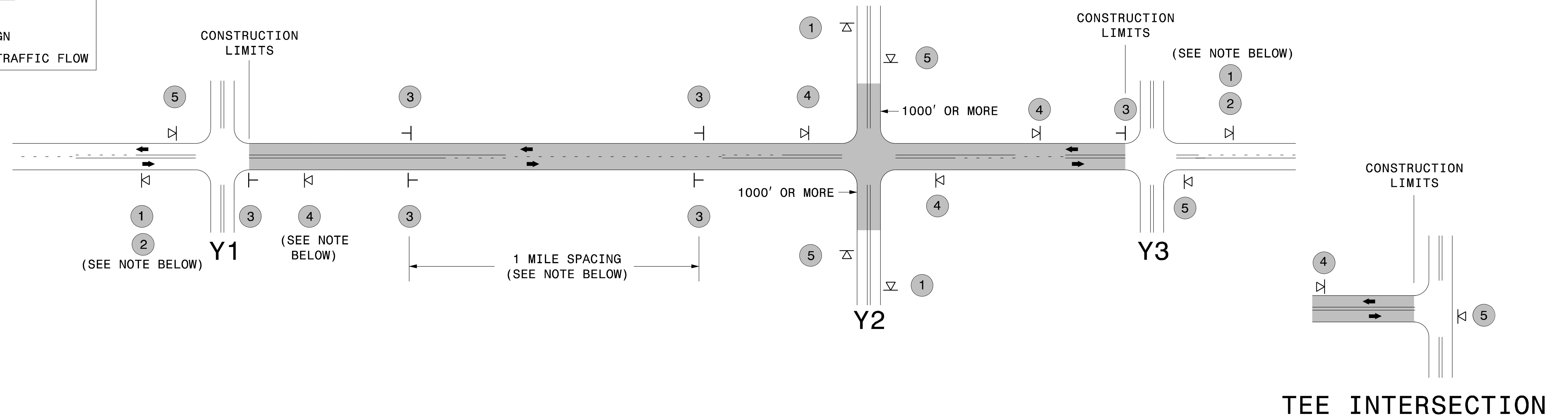

MAINLINE (-L-) SIGNING

-Y- LINE SIGNING

SIGNING NOTES AND PLACEMENT PER DIRECTION	1	 	<ul style="list-style-type: none"> - PLACE 1000' PRIOR TO BEGINNING OF CONSTRUCTION LIMITS. ONLY USED ON -Y- LINES IF RESURFACING LIMITS EXTEND 1000' ALONG -Y- LINE. - SIGN #2 ONLY USED WHEN RESURFACING LIMITS ARE 2 OR MORE MILES IN LENGTH. ROUND UP TO THE NEAREST WHOLE NUMBER. DO NOT USE FRACTIONAL OR DECIMAL NUMBERS. 	<p>STATIONARY SIGNING NOT REQUIRED FOR THE FOLLOWING -Y- LINE CONDITIONS:</p> <ol style="list-style-type: none"> 1) LESS THAN 1000' OF RESURFACING ALONG -Y- LINE 2) SUBDIVISION ROADS 3) DEAD END ROADS <p>WHEN PAVING/CONSTRUCTION ACTIVITIES PROCEED ACROSS AN UNSIGNED -Y- LINE, PORTABLE ADVANCE WARNING SIGNS SHALL BE USED ALONG THE -Y- LINE AS SHOWN BELOW. REMOVE UPON COMPLETION OF WORK.</p> <div style="display: flex; justify-content: space-around; align-items: center;"> <div style="text-align: center;"> <small>W20-1 48" X 48"</small> PLACED 500' IN ADVANCE OF FLAGGER. </div> <div style="text-align: center;"> <small>W20-7 A 48" X 48"</small> PLACED 250' IN ADVANCE OF FLAGGER. </div> </div>
	3	 	<ul style="list-style-type: none"> - ALTERNATE THE FOLLOWING TWO SIGNS: - STARTING WITH "LOOSE GRAVEL" (W8-7) FOLLOWED BY "UNMARKED PAVEMENT". - PLACE INITIALLY AT THE CONSTRUCTION LIMITS AND SPACED 1 MILE APART THEREAFTER. - AT TEE INTERSECTIONS INSTALL INITIALLY 0.5 MILE FROM INTERSECTION AND SPACE 1 MILE APART THEREAFTER. 	
	4		<ul style="list-style-type: none"> - THESE ARE FOR -Y- LINES THAT ARE "THROUGH" ROADWAYS. DEAD END AND SUBDIVISION ROADS ARE NOT "THROUGH" ROADWAYS. - INSTALL 500' +/- FROM EACH -Y- LINE APPROACH AS SHOWN ABOVE. - FOR MULTIPLE -Y- LINES THAT ARE SEPARATED BY 0.25 MILES OR LESS, TREAT AS A SINGLE UNIT AND INSTALL WITHIN 500' OF EACH APPROACH. - A MAXIMUM OF 2 SIGN SETS PER MILE. DO NOT INSTALL WHEN -Y- LINES ARE WITHIN 0.5 MILES FROM "END ROAD WORK" SIGN. 	
	5		<ul style="list-style-type: none"> PLACE 500' FOLLOWING THE END OF CONSTRUCTION LIMITS OR AS SHOWN WHEN WORK ENDS AT A 3-WAY TEE INTERSECTION. 	
	<p>THE ABOVE SIGNS ARE ALL THAT ARE REQUIRED FOR A CONTRACTOR TO BEGIN A RESURFACING CONTRACT. ANY ADDITIONAL SIGNS REQUESTED BY NCDOT DIVISIONS SHALL BE INSTALLED WITHIN 7 BUSINESS DAYS OF THE START OF CONTRACT WORK.</p>			

MAPS LESS THAN 2 MILES

FOR AST RESURFACING MAPS WITH CONSTRUCTION LIMITS LESS THAN 2 MILES IN LENGTH, USE A STATIONARY "LOOSE GRAVEL" SIGN AT THE BEGINNING CONSTRUCTION LIMIT FOLLOWED BY AN "UNMARKED PAVEMENT" SIGN MIDWAY THROUGH AND AN "END ROAD WORK" SIGN AT THE END CONSTRUCTION LIMIT.



**ADVANCE WARNING SIGNS
FOR
2-LANE ROADWAY
ASPHALT SURFACE TREATMENT**